



## Features 特点

- ◆ Various high power inductors are superior to be high saturation  
大功率，高饱和电流，低阻抗
- ◆ Magnetically shielded structure  
磁屏蔽结构
- ◆ Suitable for surface mounting equipment  
适合表面贴装
- ◆ Provided in embossed carrier tape packaging for use with automatic mounting machines  
编带包装便于自动贴装

## Application 应用

- ◆ Power supply choke for small electrical equipments such as VTR, LCD display, Notebook, communication equipment, and so on.  
用于录像机、液晶显示器、笔记本电脑、通讯设备、办公自动化等电子设备的电源扼流

## Product Identification 产品标识

**MDRH 127 - 100 M**

① ② ③ ④

- ① Series name 系列名称
- ② Product dimensions 产品尺寸：(127=12 \*12\*7mm)
- ③ Inductance Value 电感量：(100=10 $\mu$ H)
- ④ Inductance Tolerance 电感量公差：(M:20%;N:30%)
- ⑤ Tape Packing 编带包装

## Shapes And Dimensions/Recommended Footprint 外形及焊位尺寸示意图

Fig1

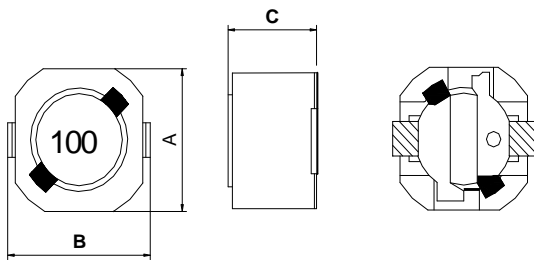

Fig2

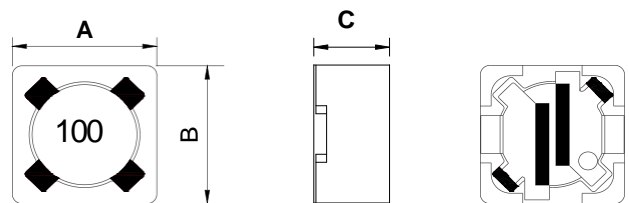

Fig3

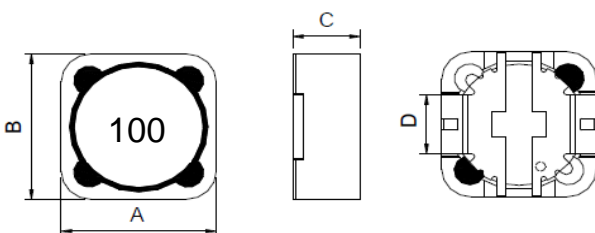
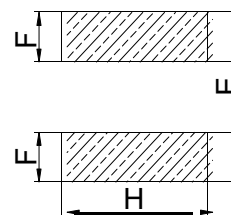

Fig4 Recommended Land Pattern 焊盘规格





Series	Shape	A	B	C	E	F	H		
MDRH62	Fig1	6.8MAX	7.0MAX	3.0MAX	7.4TYP	1.4TYP	1.9TYP		
MDRH64	Fig1	6.8MAX	7.0MAX	5.0MAX	7.4TYP	1.4TYP	1.9TYP		
MDRH73	Fig2	7.8MAX	7.8MAX	4.0MAX	8.0TYP	1.6TYP	2.2TYP		
MDRH74	Fig2	7.8MAX	7.8MAX	5.0MAX	8.0TYP	1.6TYP	2.2TYP		
MDRH104	Fig3	10.5MAX	10.5MAX	5.0MAX	10.8TYP	2.0TYP	4.4TYP		
MDRH124	Fig3	12.5MAX	12.5MAX	5.0MAX	12.8TYP	2.9TYP	5.4TYP		
MDRH125	Fig3	12.5MAX	12.5MAX	6.0MAX	12.8TYP	2.9TYP	5.4TYP		
MDRH127	Fig3	12.5MAX	12.5MAX	8.0MAX	12.8TYP	2.9TYP	5.4TYP		

## Electrical Characteristics 电气特性

### MDRH62 系列

MING - CI	Inductance	Percent	L Test	DC Resistance	Rated Current	Rated Current	Marking
P/N	L( $\mu$ H)	Tolerance	Frequency	DCR (m $\Omega$ )	Isat(A)	Irms(A)	
MDRH62-3R3M	3.3	$\pm 20\%$	100KHz,0.3V	68MAX	1.94	-----	3R3
MDRH62-4R7M	4.7	$\pm 20\%$	100KHz,0.3V	80MAX	1.63	-----	4R7
MDRH62-5R6M	5.6	$\pm 20\%$	100KHz,0.3V	96MAX	1.40	-----	5R6
MDRH62-100M	10	$\pm 20\%$	1KHz,0.3V	150MAX	1.10	-----	100
MDRH62-120M	12	$\pm 20\%$	1KHz,0.3V	200MAX	1.00	-----	120
MDRH62-150M	15	$\pm 20\%$	1KHz,0.3V	230MAX	0.90	-----	150
MDRH62-180M	18	$\pm 20\%$	1KHz,0.3V	270MAX	0.80	-----	180
MDRH62-220M	22	$\pm 20\%$	1KHz,0.3V	340MAX	0.74	-----	220
MDRH62-270M	27	$\pm 20\%$	1KHz,0.3V	380MAX	0.66	-----	270
MDRH62-330M	33	$\pm 20\%$	1KHz,0.3V	450MAX	0.59	-----	330
MDRH62-390M	39	$\pm 20\%$	1KHz,0.3V	490MAX	0.54	-----	390
MDRH62-470M	47	$\pm 20\%$	1KHz,0.3V	690MAX	0.50	-----	470
MDRH62-560M	56	$\pm 20\%$	1KHz,0.3V	780MAX	0.46	-----	560
MDRH62-680M	68	$\pm 20\%$	1KHz,0.3V	1070MAX	0.42	-----	680
MDRH62-820M	82	$\pm 20\%$	1KHz,0.3V	1210MAX	0.38	-----	820
MDRH62-101M	100	$\pm 20\%$	1KHz,0.3V	1390MAX	0.34	-----	101
MDRH62-121M	120	$\pm 20\%$	1KHz,0.3V	1900MAX	0.31	-----	121
MDRH62-151M	150	$\pm 20\%$	1KHz,0.3V	2180MAX	0.28	-----	151
MDRH62-181M	180	$\pm 20\%$	1KHz,0.3V	2770MAX	0.26	-----	181
MDRH62-221M	220	$\pm 20\%$	1KHz,0.3V	3120MAX	0.23	-----	221
MDRH62-271M	270	$\pm 20\%$	1KHz,0.3V	4380MAX	0.22	-----	271
MDRH62-331M	330	$\pm 20\%$	1KHz,0.3V	4940MAX	0.19	-----	331

Isat: Direct current at which the inductance drops approximate 25% from its value without current.

Irms: Direct current when the temperature of the product rise( $\Delta T=40^{\circ}\text{C}$ ) from  $20^{\circ}\text{C}$  ambient.



**MDRH64 系列**

MING - CI	Inductance	Percent	L Test	DC Resistance	Rated Current	Rated Current	Marking
P/N	L(μ H)	Tolerance	Frequency	DCR (mΩ)	Isat(A)	Irms(A)	
MDRH64-100MC	10	±20%	1KHz,0.3V	120MAX	1.35	----	100
MDRH64-120MC	12	±20%	1KHz,0.3V	130MAX	1.20	----	120
MDRH64-150MC	15	±20%	1KHz,0.3V	180MAX	1.10	----	150
MDRH64-180MC	18	±20%	1KHz,0.3V	240MAX	1.00	----	180
MDRH64-220MC	22	±20%	1KHz,0.3V	270MAX	0.91	----	220
MDRH64-270MC	27	±20%	1KHz,0.3V	300MAX	0.82	----	270
MDRH64-330MC	33	±20%	1KHz,0.3V	330MAX	0.75	----	330
MDRH64-390MC	39	±20%	1KHz,0.3V	370MAX	0.69	----	390
MDRH64-470MC	47	±20%	1KHz,0.3V	520MAX	0.62	----	470
MDRH64-560MC	56	±20%	1KHz,0.3V	560MAX	0.58	----	560
MDRH64-680MC	68	±20%	1KHz,0.3V	630MAX	0.52	----	680
MDRH64-820MC	82	±20%	1KHz,0.3V	710MAX	0.47	----	820
MDRH64-101MC	100	±20%	1KHz,0.3V	1030MAX	0.43	----	101
MDRH64-121MC	120	±20%	1KHz,0.3V	1150MAX	0.39	----	121
MDRH64-151MC	150	±20%	1KHz,0.3V	1680MAX	0.35	----	151
MDRH64-181MC	180	±20%	1KHz,0.3V	1870MAX	0.32	----	181
MDRH64-221MC	220	±20%	1KHz,0.3V	2080MAX	0.29	----	221
MDRH64-271MC	270	±20%	1KHz,0.3V	2370MAX	0.26	----	271
MDRH64-331MC	330	±20%	1KHz,0.3V	2670MAX	0.23	----	331
MDRH64-391MC	390	±20%	1KHz,0.3V	2940MAX	0.22	----	391
MDRH64-471MC	470	±20%	1KHz,0.3V	3930MAX	0.20	----	471
MDRH64-561MC	560	±20%	1KHz,0.3V	5430MAX	0.18	----	561
MDRH64-681MC	680	±20%	1KHz,0.3V	7320MAX	0.17	----	681
MDRH64-821MC	820	±20%	1KHz,0.3V	8240MAX	0.15	----	821
MDRH64-102MC	1000	±20%	1KHz,0.3V	9260MAX	0.14	----	102

Isat: Direct current at which the inductance drops approximate 30% from its value without current.

Irms: Direct current when the temperature of the product rise( $\Delta T=40^{\circ}C$ ) from  $20^{\circ}C$  ambient.

**MDRH73 系列**

MING - CI	Inductance	Percent	L Test	DC Resistance	Rated Current	Rated Current	Marking
P/N	L(μ H)	Tolerance	Frequency	DCR (mΩ)	Isat(A)	Irms(A)	
MDRH73-100M	10	±20%	1KHz,0.3V	72MAX	1.68	----	100
MDRH73-120M	12	±20%	1KHz,0.3V	98MAX	1.52	----	120
MDRH73-150M	15	±20%	1KHz,0.3V	130MAX	1.33	----	150
MDRH73-180M	18	±20%	1KHz,0.3V	140MAX	1.20	----	180
MDRH73-220M	22	±20%	1KHz,0.3V	190MAX	1.07	----	220
MDRH73-270M	27	±20%	1KHz,0.3V	210MAX	0.96	----	270
MDRH73-330M	33	±20%	1KHz,0.3V	240MAX	0.91	----	330
MDRH73-390M	39	±20%	1KHz,0.3V	320MAX	0.77	----	390



MDRH73-470M	47	±20%	1KHz,0.3V	360MAX	0.76	----	470
MDRH73-560M	56	±20%	1KHz,0.3V	470MAX	0.68	----	560
MDRH73-680M	68	±20%	1KHz,0.3V	520MAX	0.61	----	680
MDRH73-820M	82	±20%	1KHz,0.3V	690MAX	0.57	----	820
MDRH73-101M	100	±20%	1KHz,0.3V	790MAX	0.50	----	101
MDRH73-121M	120	±20%	1KHz,0.3V	890MAX	0.49	----	121
MDRH73-151M	150	±20%	1KHz,0.3V	1270MAX	0.43	----	151
MDRH73-181M	180	±20%	1KHz,0.3V	1450MAX	0.39	----	181
MDRH73-221M	220	±20%	1KHz,0.3V	1650MAX	0.35	----	221
MDRH73-271M	270	±20%	1KHz,0.3V	2310MAX	0.32	----	271
MDRH73-331M	330	±20%	1KHz,0.3V	2620MAX	0.28	----	331
MDRH73-391M	390	±20%	1KHz,0.3V	2940MAX	0.26	----	391
MDRH73-471M	470	±20%	1KHz,0.3V	4180MAX	0.24	----	471
MDRH73-561M	560	±20%	1KHz,0.3V	4670MAX	0.22	----	561
MDRH73-681M	680	±20%	1KHz,0.3V	5730MAX	0.19	----	681
MDRH73-821M	820	±20%	1KHz,0.3V	6540MAX	0.18	----	821
MDRH73-102M	1000	±20%	1KHz,0.3V	9440MAX	0.16	----	102

Isat: Direct current at which the inductance drops approximate 30% from its value without current.

Irms: Direct current when the temperature of the product rise( $\Delta T=40^{\circ}C$ ) from  $20^{\circ}C$  ambient.

### MDRH74 系列

MING - CI	Inductance	Percent	L Test	DC Resistance	Rated Current	Rated Current	Marking
P/N	L( $\mu H$ )	Tolerance	Frequency	DCR (m $\Omega$ )	Isat(A)	Irms(A)	
MDRH74-100M	10	±20%	1KHz,0.3V	49MAX	1.84	----	100
MDRH74-120M	12	±20%	1KHz,0.3V	58MAX	1.71	----	120
MDRH74-150M	15	±20%	1KHz,0.3V	81MAX	1.47	----	150
MDRH74-180M	18	±20%	1KHz,0.3V	91MAX	1.31	----	180
MDRH74-220M	22	±20%	1KHz,0.3V	110MAX	1.23	----	220
MDRH74-270M	27	±20%	1KHz,0.3V	150MAX	1.12	----	270
MDRH74-330M	33	±20%	1KHz,0.3V	170MAX	0.96	----	330
MDRH74-390M	39	±20%	1KHz,0.3V	230MAX	0.91	----	390
MDRH74-470M	47	±20%	1KHz,0.3V	260MAX	0.88	----	470
MDRH74-560M	56	±20%	1KHz,0.3V	350MAX	0.75	----	560
MDRH74-680M	68	±20%	1KHz,0.3V	380MAX	0.69	----	680
MDRH74-820M	82	±20%	1KHz,0.3V	430MAX	0.61	----	820
MDRH74-101M	100	±20%	1KHz,0.3V	610MAX	0.60	----	101
MDRH74-121M	120	±20%	1KHz,0.3V	660MAX	0.52	----	121
MDRH74-151M	150	±20%	1KHz,0.3V	880MAX	0.46	----	151
MDRH74-181M	180	±20%	1KHz,0.3V	980MAX	0.42	----	181
MDRH74-221M	220	±20%	1KHz,0.3V	1170MAX	0.36	----	221
MDRH74-271M	270	±20%	1KHz,0.3V	1640MAX	0.34	----	271
MDRH74-331M	330	±20%	1KHz,0.3V	1860MAX	0.32	----	331
MDRH74-391M	390	±20%	1KHz,0.3V	2850MAX	0.29	----	391
MDRH74-471M	470	±20%	1KHz,0.3V	3010MAX	0.26	----	471



MDRH74-561M	560	±20%	1KHz,0.3V	3620MAX	0.23	----	561
MDRH74-681M	680	±20%	1KHz,0.3V	4630MAX	0.22	----	681
MDRH74-821M	820	±20%	1KHz,0.3V	5200MAX	0.20	----	821
MDRH74-102M	1000	±20%	1KHz,0.3V	6000MAX	0.18	----	102

Isat: Direct current at which the inductance drops approximate 30% from its value without current.

Irms: Direct current when the temperature of the product rise( $\Delta T=40^{\circ}\text{C}$ ) from  $20^{\circ}\text{C}$  ambient

### MDRH104 系列

MING - CI	Inductance	Percent	L Test	DC Resistance	Rated Current	Rated Current	Marking
P/N	L( $\mu\text{H}$ )	Tolerance	Frequency	DCR (m $\Omega$ )	Isat(A)	Irms(A)	
MDRH104-4R7M	4.7	±20%	100KHz,0.3V	35MAX	3.20	----	4R7
MDRH104-6R8M	6.8	±20%	100KHz,0.3V	44MAX	2.80	----	6R8
MDRH104-100M	10	±20%	1KHz,0.3V	50MAX	2.40	----	100
MDRH104-120M	12	±20%	1KHz,0.3V	54MAX	2.25	----	120
MDRH104-150M	15	±20%	1KHz,0.3V	61MAX	2.00	----	150
MDRH104-180M	18	±20%	1KHz,0.3V	84MAX	1.80	----	180
MDRH104-220M	22	±20%	1KHz,0.3V	94MAX	1.65	----	220
MDRH104-270M	27	±20%	1KHz,0.3V	110MAX	1.45	----	270
MDRH104-330M	33	±20%	1KHz,0.3V	150MAX	1.35	----	330
MDRH104-390M	39	±20%	1KHz,0.3V	170MAX	1.20	----	390
MDRH104-470M	47	±20%	1KHz,0.3V	210MAX	1.10	----	470
MDRH104-560M	56	±20%	1KHz,0.3V	230MAX	1.00	----	560
MDRH104-680M	68	±20%	1KHz,0.3V	260MAX	0.93	----	680
MDRH104-820M	82	±20%	1KHz,0.3V	360MAX	0.84	----	820
MDRH104-101M	100	±20%	1KHz,0.3V	410MAX	0.76	----	101
MDRH104-121M	120	±20%	1KHz,0.3V	450MAX	0.70	----	121
MDRH104-151M	150	±20%	1KHz,0.3V	640MAX	0.63	----	151
MDRH104-181M	180	±20%	1KHz,0.3V	840MAX	0.57	----	181
MDRH104-221M	220	±20%	1KHz,0.3V	960MAX	0.52	----	221
MDRH104-271M	270	±20%	1KHz,0.3V	1070MAX	0.47	----	271
MDRH104-331M	330	±20%	1KHz,0.3V	1370MAX	0.43	----	331
MDRH104-391M	390	±20%	1KHz,0.3V	1550MAX	0.39	----	391
MDRH104-471M	470	±20%	1KHz,0.3V	1740MAX	0.36	----	471

Isat: Direct current at which the inductance drops approximate 30% from its value without current.

Irms: Direct current when the temperature of the product rise( $\Delta T=40^{\circ}\text{C}$ ) from  $20^{\circ}\text{C}$  ambient

### MDRH124 系列

MING - CI	Inductance	Percent	L Test	DC Resistance	Rated Current	Rated Current	Marking
P/N	L( $\mu\text{H}$ )	Tolerance	Frequency	DCR (m $\Omega$ )	Isat(A)	Irms(A)	
MDRH124-1R0M	1.0	±20%	100KHz,0.3V	1MAX	8.0	----	1R0
MDRH124-2R2M	2.2	±20%	100KHz,0.3V	14MAX	4.9	----	2R2
MDRH124-3R3M	3.3	±20%	100KHz,0.3V	15MAX	4.5	----	3R3
MDRH124-4R7M	4.7	±20%	100KHz,0.3V	18MAX	5.7	----	4R7



MDRH124-5R6M	5.6	±20%	100KHz,0.3V	20MAX	5.2	----	5R6
MDRH124-6R8M	6.8	±20%	100KHz,0.3V	23MAX	4.9	----	6R8
MDRH124-8R2M	8.2	±20%	100KHz,0.3V	26MAX	4.6	----	8R2
MDRH124-100M	10	±20%	1KHz,0.3V	28MAX	4.5	----	100
MDRH124-120M	12	±20%	1KHz,0.3V	38MAX	4.0	----	120
MDRH124-150M	15	±20%	1KHz,0.3V	50MAX	3.2	----	150
MDRH124-180M	18	±20%	1KHz,0.3V	57MAX	3.1	----	180
MDRH124-220M	22	±20%	1KHz,0.3V	66MAX	2.9	----	220
MDRH124-270M	27	±20%	1KHz,0.3V	80MAX	2.8	----	270
MDRH124-330M	33	±20%	1KHz,0.3V	97MAX	2.7	----	330
MDRH124-390M	39	±20%	1KHz,0.3V	132MAX	2.1	----	390
MDRH124-470M	47	±20%	1KHz,0.3V	160MAX	1.9	----	470
MDRH124-560M	56	±20%	1KHz,0.3V	190MAX	1.8	----	560
MDRH124-680M	68	±20%	1KHz,0.3V	220MAX	1.5	----	680
MDRH124-820M	82	±20%	1KHz,0.3V	260MAX	1.3	----	820
MDRH124-101M	100	±20%	1KHz,0.3V	310MAX	1.2	----	101
MDRH124-121M	120	±20%	1KHz,0.3V	380MAX	1.1	----	121
MDRH124-151M	150	±20%	1KHz,0.3V	530MAX	0.95	----	151
MDRH124-181M	180	±20%	1KHz,0.3V	620MAX	0.85	----	181
MDRH124-221M	220	±20%	1KHz,0.3V	700MAX	0.80	----	221
MDRH124-271M	270	±20%	1KHz,0.3V	870MAX	0.60	----	271
MDRH124-331M	330	±20%	1KHz,0.3V	990MAX	0.50	----	331

Isat: Direct current at which the inductance drops approximate 30% from its value without current.

Irms: Direct current when the temperature of the product rise( $\Delta T=40^{\circ}C$ ) from  $20^{\circ}C$  ambient

### MDRH125 系列

MING - CI	Inductance	Percent	L Test	DC Resistance	Rated Current	Rated Current	Marking
P/N	L( $\mu H$ )	Tolerance	Frequency	DCR (m $\Omega$ )	Isat(A)	Irms(A)	
MDRH125-1R0M	1.0	±20%	100KHz,0.3V	10MAX	8.0	----	1R0
MDRH125-2R2M	2.2	±20%	100KHz,0.3V	14MAX	7.8	----	2R2
MDRH125-3R3M	3.3	±20%	100KHz,0.3V	14MAX	8.0	----	3R3
MDRH125-8R2M	8.2	±20%	100KHz,0.3V	21MAX	4.4	----	8R2
MDRH125-100M	10	±20%	1KHz,0.3V	25MAX	4.0	----	100
MDRH125-120M	12	±20%	1KHz,0.3V	27MAX	3.5	----	120
MDRH125-150M	15	±20%	1KHz,0.3V	30MAX	3.3	----	150
MDRH125-180M	18	±20%	1KHz,0.3V	34MAX	3.0	----	180
MDRH125-220M	22	±20%	1KHz,0.3V	36MAX	2.8	----	220
MDRH125-270M	27	±20%	1KHz,0.3V	51MAX	2.3	----	270
MDRH125-330M	33	±20%	1KHz,0.3V	57MAX	2.1	----	330
MDRH125-390M	39	±20%	1KHz,0.3V	68MAX	2.0	----	390
MDRH125-470M	47	±20%	1KHz,0.3V	75MAX	1.8	----	470
MDRH125-560M	56	±20%	1KHz,0.3V	110MAX	1.7	----	560
MDRH125-680M	68	±20%	1KHz,0.3V	120MAX	1.5	----	680
MDRH125-820M	82	±20%	1KHz,0.3V	140MAX	1.4	----	820



MDRH125-101M	100	±20%	1KHz,0.3V	160MAX	1.3	----	101
MDRH125-121M	120	±20%	1KHz,0.3V	170MAX	1.1	----	121
MDRH125-151M	150	±20%	1KHz,0.3V	230MAX	1.0	----	151
MDRH125-181M	180	±20%	1KHz,0.3V	290MAX	0.9	----	181
MDRH125-221M	220	±20%	1KHz,0.3V	400MAX	0.8	----	221
MDRH125-271M	270	±20%	1KHz,0.3V	460MAX	0.75	----	271
MDRH125-331M	330	±20%	1KHz,0.3V	510MAX	0.68	----	331
MDRH125-391M	390	±20%	1KHz,0.3V	690MAX	0.65	----	391
MDRH125-471M	470	±20%	1KHz,0.3V	770MAX	0.58	----	471
MDRH125-561M	560	±20%	1KHz,0.3V	860MAX	0.54	----	561
MDRH125-681M	680	±20%	1KHz,0.3V	1200MAX	0.48	----	681

Isat: Direct current at which the inductance drops approximate 30% from its value without current.

Irms: Direct current when the temperature of the product rise( $\Delta T=40^{\circ}C$ ) from  $20^{\circ}C$  ambient.

### MDRH127 系列

MING - CI	Inductance	Percent	L Test	DC Resistance	Rated Current	Rated Current	Marking
P/N	L( $\mu H$ )	Tolerance	Frequency	DCR (m $\Omega$ )	Isat(A)	Irms(A)	
MDRH127-1R0M	1.0	±20%	100KHz,0.3V	6MAX	12.0	----	1R0
MDRH127-2R2M	2.2	±20%	100KHz,0.3V	11.5MAX	8.0	----	2R2
MDRH127-3R3M	3.3	±20%	100KHz,0.3V	13MAX	8.0	----	3R3
MDRH127-4R7M	4.7	±20%	100KHz,0.3V	15.8MAX	6.8	----	4R7
MDRH127-6R8M	6.8	±20%	100KHz,0.3V	19MAX	6.6	----	6R8
MDRH127-8R2M	8.2	±20%	100KHz,0.3V	20MAX	5.6	----	8R2
MDRH127-100M	10	±20%	1KHz,0.3V	21.6MAX	5.4	----	100
MDRH127-120M	12	±20%	1KHz,0.3V	24.3MAX	4.9	----	120
MDRH127-150M	15	±20%	1KHz,0.3V	27MAX	4.5	----	150
MDRH127-180M	18	±20%	1KHz,0.3V	39.2MAX	3.9	----	180
MDRH127-220M	22	±20%	1KHz,0.3V	43.2MAX	3.6	----	220
MDRH127-270M	27	±20%	1KHz,0.3V	45.9MAX	3.4	----	270
MDRH127-330M	33	±20%	1KHz,0.3V	64.8MAX	3.0	----	330
MDRH127-390M	39	±20%	1KHz,0.3V	72.9MAX	2.75	----	390
MDRH127-470M	47	±20%	1KHz,0.3V	100MAX	2.50	----	470
MDRH127-560M	56	±20%	1KHz,0.3V	110MAX	2.35	----	560
MDRH127-680M	68	±20%	1KHz,0.3V	140MAX	2.10	----	680
MDRH127-820M	82	±20%	1KHz,0.3V	160MAX	1.95	----	820
MDRH127-101M	100	±20%	1KHz,0.3V	220MAX	1.70	----	101
MDRH127-121M	120	±20%	1KHz,0.3V	250MAX	1.60	----	121
MDRH127-151M	150	±20%	1KHz,0.3V	280MAX	1.42	----	151
MDRH127-181M	180	±20%	1KHz,0.3V	350MAX	1.30	----	181
MDRH127-221M	220	±20%	1KHz,0.3V	390MAX	1.16	----	221
MDRH127-271M	270	±20%	1KHz,0.3V	560MAX	1.06	----	271
MDRH127-331M	330	±20%	1KHz,0.3V	640MAX	0.95	----	331
MDRH127-391M	390	±20%	1KHz,0.3V	700MAX	0.88	----	391
MDRH127-471M	470	±20%	1KHz,0.3V	980MAX	0.79	----	471



MDRH127-561M	560	±20%	1KHz,0.3V	1070MAX	0.73	----	561
MDRH127-681M	680	±20%	1KHz,0.3V	1460MAX	0.67	----	681
MDRH127-821M	820	±20%	1KHz,0.3V	1640MAX	0.60	----	821
MDRH127-102M	1000	±20%	1KHz,0.3V	1820MAX	0.55	----	102

Isat: Direct current at which the inductance drops approximate 30% from its value without current.

Irms: Direct current when the temperature of the product rise( $\Delta T=40^{\circ}\text{C}$ ) from  $20^{\circ}\text{C}$  ambient.

## Taping Dimension 包装尺寸

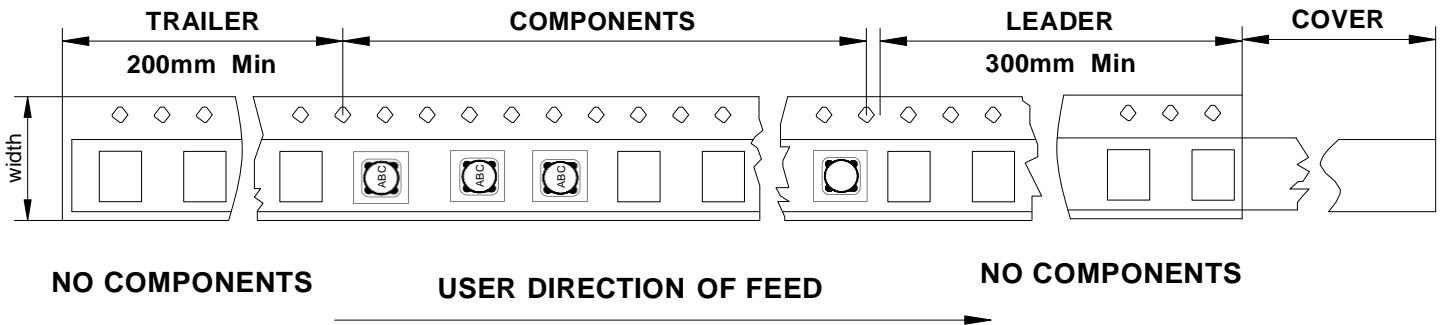

Series	Qty per Reel	Reel Size	Reel Box	Outer Box
MDRH62	1500PCS	13Inch*16width	4500PCS(340*340*75mm)	13500PCS(358*358*250mm)
MDRH64	1000PCS	13Inch*16width	3000PCS(340*340*75mm)	9000PCS(358*358*250mm)
MDRH73	1000PCS	13Inch*16width	3000PCS(340*340*75mm)	9000PCS(358*358*250mm)
MDRH74	1000PCS	13Inch*16width	3000PCS(340*340*75mm)	9000PCS(358*358*250mm)
MDRH104	800PCS	13Inch*24width	1600PCS(340*340*75mm)	4800PCS(358*358*250mm)
MDRH124	600PCS	13Inch*24width	1200PCS(340*340*75mm)	3600PCS(358*358*250mm)
MDRH125	600PCS	13Inch*24width	1200PCS(340*340*75mm)	3600PCS(358*358*250mm)
MDRH127	500PCS	13Inch*24width	1000PCS(340*340*75mm)	3000PCS(358*358*250mm)